



OAKWOOD LODGE 2

Step through the sliding patio doors and into the **Oakwood Lodge 2** and you will be immediately struck by the large open plan living area with its large 4-seater L-shaped sofa and optional contrasting feature armchair. A modern floating drawer unit

with a media wall above contains a black electric fire.

The **Oakwood Lodge 2** has a freestanding dining table and 6 chairs. Mirror doors conceal the washer/dryer and offer storage. The reading nook in the entrance has coat hooks and built-in storage.

For total peace of mind all our holiday homes and lodges come with a **COMPREHENSIVE WARRANTY**

See page 7 for further details



Oakwood Lodge 2

kitchen takes luxury to a new level with its island unit complete with storage cupboards and wine rack. An integrated electric oven with 4-burner gas hob and extractor is complemented with an integrated 70/30 fridge/freezer and microwave.



The **Oakwood Lodge 2** illustrated is the 40ft x 20ft – 2 bedrooms. The model shown has the optional two tone rigid vinyl exterior with optional graphite windows and doors.

Note: Deluxe bedding set, lounge scatters, TV and interior accessories are for display purposes only.



The luxury continues in the **Oakwood Lodge 2** master bedroom with its sliding mirrored door access to a large ensuite shower with WC and twin basins. With robes behind both sides of the mirrored doors, a kingsize bed and dressing table with stool complete this stunning bedroom.





The second bedroom in the **Oakwood Lodge 2** features 3ft single beds, wardrobe and a dressing table with stool and large mirror above.

The ensuite bathroom to the second bedroom has a full size bath, WC, wash basin and extractor.

The Oakwood Lodge 2 is a truly special holiday home. Clever contemporary design paired with high quality

fixtures and fittings, make this a model everyone will be talking about as it sets the new standard for luxury and sophistication.



There are some great facilities on offer at holiday parks today so, if you're a fisherman, don't forget to take your fishing tackle with you.





Model illustrated 40ft x 20ft – 2 bed

- A Kitchen** with island unit with wine rack, electric oven with 4 ring gas hob, extractor hood, integrated fridge/freezer & microwave.
- B Lounge** with large L-shaped 4 seater sofa and optional feature armchair. Media wall above floating drawer unit with electric fire.
- C Dining Area** with freestanding dining table and 6 dining chairs. Mirror doors conceal the washer/dryer and offer additional storage.
- D Entrance Bench** with padded seat featuring plenty of storage and hanging space.
- E Main Bathroom** with bath, shower over bath, bath screen, wash basin, WC and extractor fan. Also accessed from twin bedroom.
- F Master Bedroom** with kingsize bed, sliding mirror door access to ensuite with robes either side & dressing table with cube style stool.
- G Twin Bedroom** with two 3ft single beds, wardrobe, dressing table with stool and bedside table.
- H Ensuite** with shower cubicle, twin countertop basins, WC and extractor fan.



STANDARD FEATURES

Lounge

L-shaped 4 seater sofa	✓
Media wall with floating drawer unit	✓
Stylish black electric fire	✓
Entrance storage bench and coat hooks	✓

Kitchen

Island unit with storage cupboards & wine rack	✓
Electric oven	✓
4 burner gas hob with electric extractor hood	✓
Integrated 70/30 fridge/freezer	✓
Integrated microwave	✓

Dining Area

Freestanding dining table and chairs	✓
Feature sliding mirrored doors concealing space for 1 optional appliance & storage	✓

Bathroom(s)

Main bathroom with shower over bath with wet wall and concertina bath screen	✓
Ensuite to second bedroom with bath, WC and twin sink (2 bed models only)	✓
Extractor fan to main bathroom & ensuite	✓

Master Bedroom

Sliding doors to robe & storage	✓
Kingsize lift up bed	✓
Access to ensuite through sliding mirrored doors (in 2-bed models)	✓

Bedroom(s)

3ft single beds to twin room	✓
------------------------------	---

Throughout

Central heating	✓
Extra insulation	✓
Low energy lighting	✓
Sockets with USB port	✓

Exterior

Fully galvanised chassis	✓
PVC double glazing	✓
Rigid PVC exterior finish	✓
Front sliding patio doors	✓

Extra dining chairs	
2 x bar stools	
Pull out bed to lounge	
Lounge footstool	
Lounge scatter cushions	
Coffee table	
Lounge armchair	
Bedside lamps to master bedroom x 2	
Gazunder twin bed	
TV points & co-ax to bedrooms	
Standard bedding set	
Deluxe bedding set	
Shower cubicle in lieu of bath	

POPULAR OPTIONS

Ultrawarm insulation	
BS3632 residential specification	
Downlighters under front eaves x 2	
Upgrade to graphite windows	
Canexel cladding white windows	
Canexel cladding coloured windows	
Timber cladding oak windows	
Front elevation accent panel quartz	
Tongue & groove panelled ceiling	
Freestanding full size washer/dryer*	
Freestanding full size washing machine*	
Integrated 18 bottle wine cooler	
Integrated full size dishwasher*	

**Only 2 full size appliances per model*

Please take a moment to choose which options you would like to be included in your new Oakwood Lodge.

You can tick the appropriate box, which will help you specify your new holiday home.

Please see the matrix on page 52 for a comprehensive list of options.

FLOOR PLANS

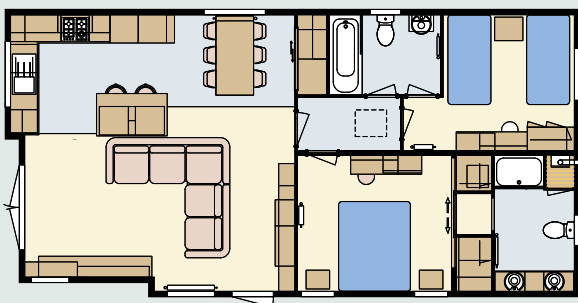

Front French Doors 40 x 20 – 2 bedroom/4 berth

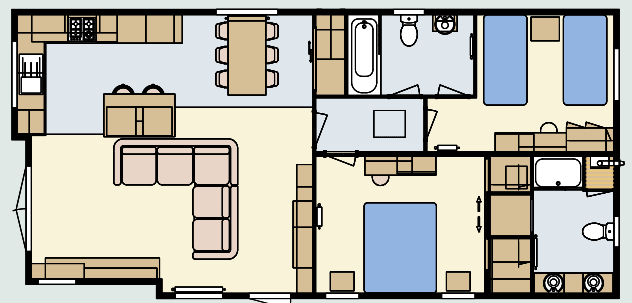

Front French Doors 42 x 20 – 2 bedroom/4 berth

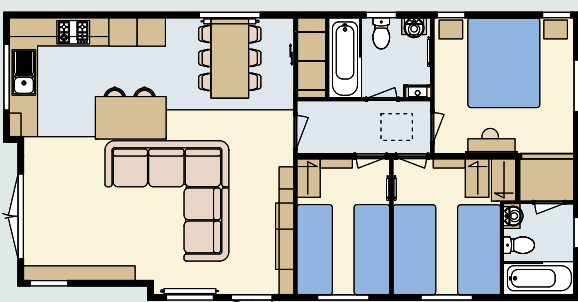

Front French Doors 40 x 20 – 3 bedroom/6 berth

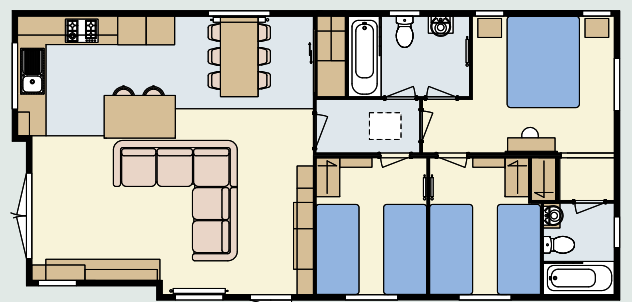

Front French Doors 42 x 20 – 3 bedroom/6 berth