

# THE TWILIGHT



## Warmth and comfort

The Twilight by Sunseeker Holiday Homes offers an easy step into holiday home ownership combining luxury and an accessible price point.

The Twilight combines all elements of our tried and tested holiday homes, with a fresh modern feel to suit today's modern family.

The Twilight combines practicality with a warm and evolutionary modern interior design. As with all Sunseeker Holiday Homes, double glazing and central heating is provided standard.



## HIGHLIGHTS

- Sociable v-shaped kitchen with a peninsula unit to the lounge
- Extensive seating in the lounge space incorporating fold-out double bed
- Media unit and modern fireplace with open shelving
- Double glazing and central heating
- Spacious family bathroom and en suite cubicle to the master bedroom.



# The Twilight

The Twilight is entered via a large entrance lobby and its innovative layout ensure the best possible use of space throughout and a light, bright and airy feel. The kitchen offers good use of space ensuring everything is within easy reach while offering ample space to work as well as modern integrated appliances including oven, hob, extractor fan and fridge-freezer.

The Twilights' lounge offers ample seating and a fold-out double bed. In addition, extra seating is provided to the dining area snug and an extra stool for use throughout the holiday home. A shelved media unit houses the electric fire with television situated above, offering additional display shelving to add those personal touches. The family shower room makes great use of the space in a practical layout. Opposite sits a twin bedroom and spacious adjacent master suite with spacious triple built-in wardrobes and inset en suite comprising of WC and washbasin.

## Twilight layout and accommodation

This 35 x 12ft model offers an innovative open plan layout allowing for a spacious and practical, kitchen, lounge and dining area. The Twilight offers a generous size lobby, shared family shower room, twin bedroom and master with en suite WC and washbasin. There is a further pull-out double bed in the lounge to accommodate additional guests in comfort.

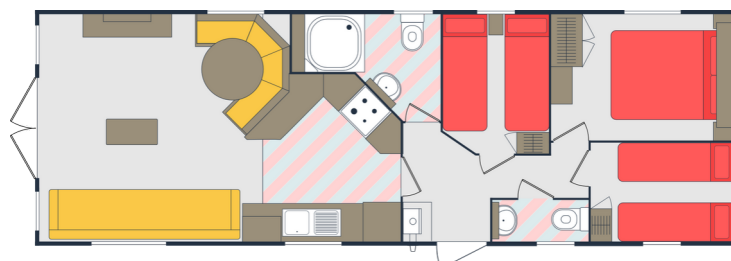

35 x 12 ft 3 bedroom with front window

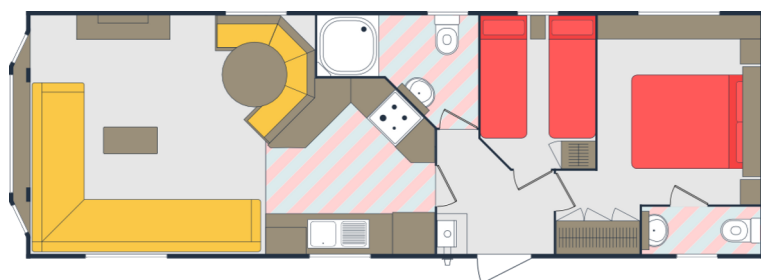

35 x 12 ft 2 bedroom with front window

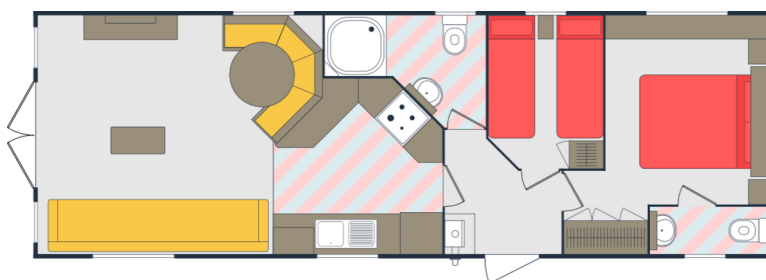

35 x 12 ft 2 bedroom with front door

Sunseeker Holiday Homes reserves the right to change any materials, fittings etc shown in this brochure and without prior notice. Photography may show features that are not standard. This includes props that are used for illustrative purposes. All Sunseeker Holiday Homes are built to EN1647 or BS3632 unless otherwise stated. E&OE



**SUNSEEKER**  
HOLIDAY HOMES

**SUNSEEKER HOLIDAY HOMES LTD.**

Marfleet Works, Valletta Street, Hull, HU9 5NP 01482 231909  
info@sunseekerholidayhomes.co.uk www.sunseekerholidayhomes.co.uk

Company number: 11912005 (Registered in England and Wales) VAT Reg: 320 4807 35