

O

ONYX 3

The incredible design in the Atlas Onyx makes an instant impression, offering a unique style and sophistication that will satisfy the most discerning of holiday home owners.



**ACCENT
ARMCHAIR**

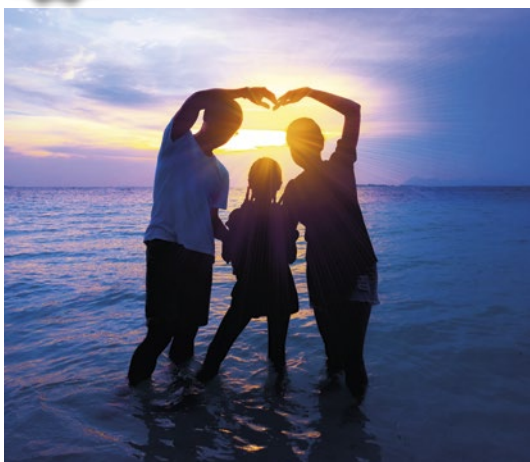

Model illustrated 38 x 12 – 2 bedroom. Duvets, pillows, bedrunner, TV, DVD player, and all other ornaments are for display only.



**BREAKFAST
BAR**



Standard Features



Cooker



**Electric
Fire**



**Fridge/
Freezer**



Sofa Bed



**Space For
Microwave**



The Onyx is bright and airy with beautiful soft furnishings that complement the lounge and bedroom areas, making this holiday home a real head turner.



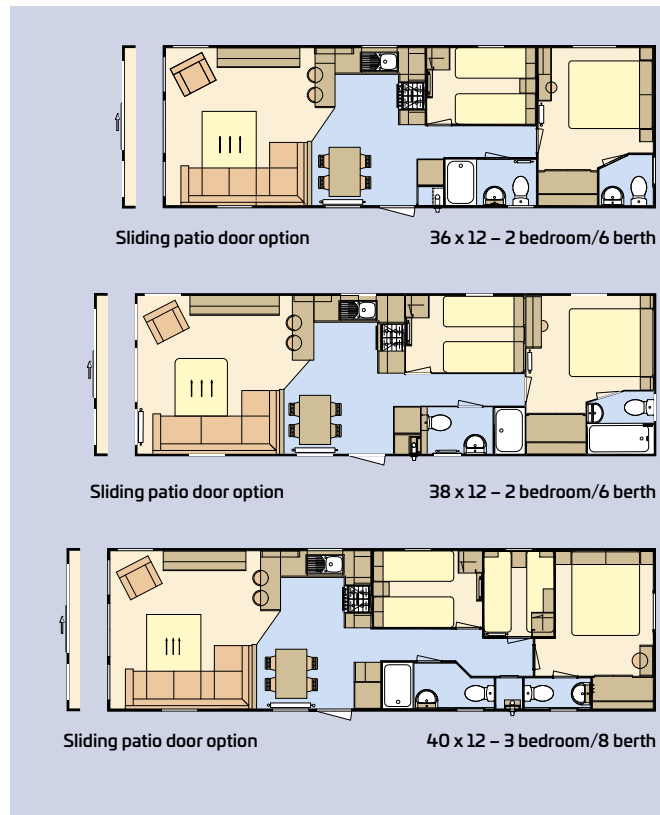

STANDARD FEATURE HIGHLIGHTS

- En-suite to 38 x 12 – 2 bedroom model
- En-suite WC to 36 x 12 – 2 bed and 40 x 12 – 3 bedroom model
- Exterior light
- Pull out bed to lounge
- Sockets with USB port
- Free standing dining table and chairs
- Recirculating electric extractor hood
- Integrated oven and grill with 4 ring hob and electric ignition
- Integrated fridge freezer
- Appliance shelf and socket
- Over bed reading lights
- Bath to 38 x 12 – 2 bedroom model
- Breakfast bar complete with 2 stools
- L shape seating and feature armchair
- Extractor fan to main bathroom/shower room

POPULAR SELECTED OPTIONS

- Central heating
- PVC double glazing
- Extra insulation
- Sliding patio doors including 2 downlighters
- Integrated microwave
- Pre-galvanised chassis or fully galvanised chassis
- Coffee table
- TV points to master bedroom and twin bedroom complete with signal booster
- One full size integrated appliance
- Gas strut metal lift up bed to master bedroom
- Standard bedding set or de-luxe bedding set (see pages 80–81)
- Shower over bath complete with wet wall and concertina bath screen in 38 x 12 – 2 bedroom model
- Shower cubicle in lieu of bath
- Gazunder twin beds
- Environmental colours, rigid PVC, Canexel or timber cladding options

Please see our matrix at the back of the brochure for a comprehensive list of options.