

THE SUPREME



Luxurious and inviting

The Supreme by Sunseeker Holiday Homes offers both sophistication and luxury. Stunning both inside and out, the Supreme is a wonderful purchase for the discerning holiday maker.

A real home from home, the interior has been designed with luxury in mind across all fixtures, fittings and soft furnishing. The holiday home is furnished with a colour palette of plush blues, natural shades and striking yellows and gold to appeal to all tastes.



HIGHLIGHTS

- Freestanding high-quality furniture and feature fireplace
- Full sliding doors to the front elevation
- Five-burner hob alongside very spacious kitchen
- En suite shower room and dressing area in the master bedroom
- Lift-up bed in the master bedroom for additional storage.



The Supreme

The Supreme features an open-plan living area with a traditional feel allowing for space and comfort. The home offers a feature wood-burning effect fireplace, with space for a television above and optional accent chair, or alternative corner media unit. The kitchen offers a good range of integrated appliances including fridge-freezer, five-burner hob with extractor plus oven and microwave. The Supreme includes a four-seater dining table taking into account space and luxury. The master bedroom offers an impressive and comfortable space with feature headboard, large double wardrobe and dressing table with handy shelving and inset mirror. Through to the en suite, the home comprises a large walk-in shower, WC and his and hers style wash-handbasin with ample shelving. The second twin bedroom offers a deep inset storage cupboard with draw space and plush candy stripe headboards. The overhead units offer ample storage space and a handy shelving/display area. The opposite family bathroom offers the benefit of a large walk-in shower as well as wash-handbasin and WC.

Supreme layout and accommodation

In size, the Supreme measures 41 x 13ft and offers a signature angular window wall to the front and into the lounge. Entry is via the sliding doors to the front elevation, or into the kitchen/diner from the side. There are two shower-rooms in the Supreme - one in the family bathroom and the other as the en suite to the master bedroom. A second twin bedroom with ample storage and dressing table completes the Supreme.

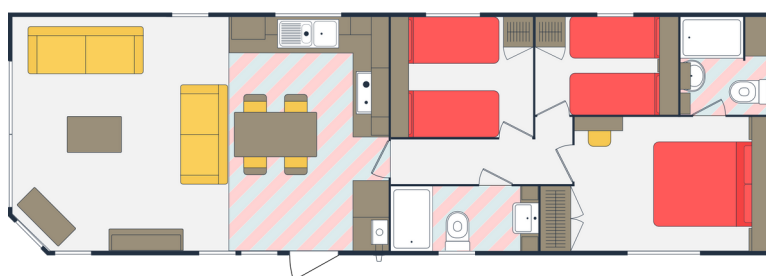

41 x 13 ft 3 bedroom

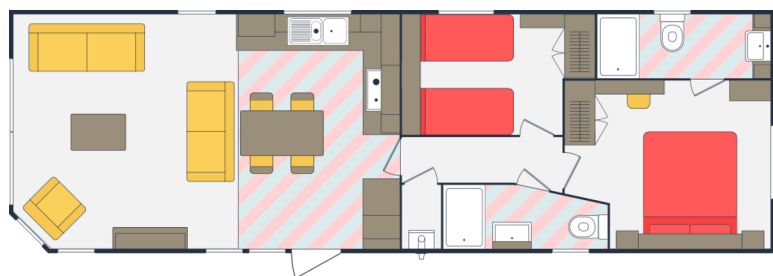

41 x 13 ft 2 bedroom with accent chair

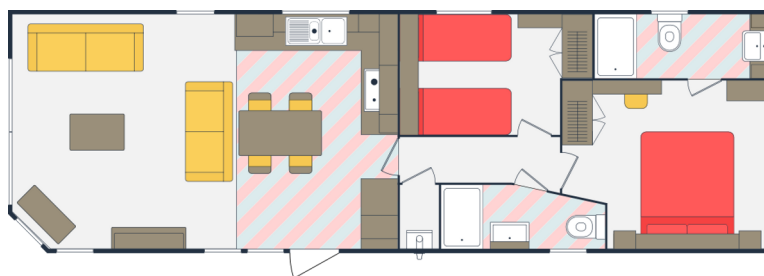

41 x 13 ft 2 bedroom

Sunseeker Holiday Homes reserves the right to change any materials, fittings etc shown in this brochure and without prior notice. Photography may show features that are not standard. This includes props that are used for illustrative purposes. All Sunseeker Holiday Homes are built to EN1647 or BS3632 unless otherwise stated. E&OE



SUNSEEKER
HOLIDAY HOMES

SUNSEEKER HOLIDAY HOMES LTD.

Marfleet Works, Valletta Street, Hull, HU9 5NP 01482 231909

info@sunseekerholidayhomes.co.uk www.sunseekerholidayhomes.co.uk

Company number: 11912005 (Registered in England and Wales) VAT Reg: 320 4807 35