



JASMINE LODGE 2

The **Jasmine Lodge 2** living area is tastefully decorated with light wood panelling. Featuring sliding patio doors, freestanding 2 and 3-seater sofas and contemporary electric fire, this model also

has central heating, PVC double glazing and extra insulation as standard.

The dining area has a freestanding table and 4 soft upholstered chairs.

For total peace of mind all our holiday homes and lodges come with a **COMPREHENSIVE WARRANTY**

See page 7 for further details



The **Jasmine Lodge 2** kitchen is a real show-stopper with its double height storage, integrated appliances and stylish black composite 1.5 bowl sink. The Fakro roof lights (standard on door side) let light flood in and create a stunning space for food preparation.



The **Jasmine Lodge 2** illustrated is the 43ft x 14ft. The 2 bedroom layout includes optional French doors in the master bedroom and pull out larder unit in the kitchen.

Note: Deluxe bedding set, lounge scatters, TV and interior accessories are for display purposes only.



The **Jasmine Lodge 2** master bedroom (above) has a king size lift up bed with light wood fitted furniture and large walk-in wardrobe. The 2 bed model has an ensuite shower to the twin bedroom (right) with sliding mirrored robes and Fakro roof-light.





All models of the **Jasmine Lodge 2** have 2 showers complete with fitted wash basin, WC and extractor fan.

The 2 bedroom model features 2 ensuite including innovative access from both the master bedroom and the hallway.

Unique to the Atlas range, the Jasmine Lodge 2-bed has the option of French doors in the master bedroom to the side or rear aspect – allowing you the chance to enjoy the fresh morning air as soon as you wake up.

After an absence of a couple of years, the brand new, re-imagined **Jasmine Lodge 2** really is the ideal luxury holiday home to sit back, relax and enjoy life to the full.



The Jasmine Lodge is made for relaxation. After all that's what holidays are for.





Model illustrated 43ft x 14ft – 2 bed

A Lounge with 2 seater sofa and 3 seater sofa with pull out bed, designer scatter cushions and sliding front patio doors.

B Dining Area with freestanding dining table and soft upholstered luxury dining chairs.

C Kitchen with high level electric oven and grill and 5-burner gas hob; and integrated fridge/freezer, microwave and dishwasher.

D Twin Bedroom with two 3ft single beds, sliding mirrored robes and dressing table.

E Main Bathroom with shower cubicle, fitted washbasin, WC and extractor fan.

F Ensuite with shower cubicle, fitted wash basin, WC and extractor fan.

G Walk-in Wardrobe with plenty of hanging space, shelves and drawer storage.

H Master Bedroom with kingsize lift up bed, dressing table and feature dresser chair.



STANDARD FEATURES

Lounge

Freestanding 3-seater suite (with pull out bed)	✓
Freestanding 2-seater suite	✓
Coffee table	✓
Feature wall panelling	✓
TV point	✓

Kitchen

High level electric oven	✓
5 burner hob with electric extractor hood	✓
Black composite 1.5 bowl sink with matching mixer tap	✓
Double height storage cupboard	✓
Integrated 70/30 fridge/freezer	✓
Integrated dishwasher	✓
Integrated microwave	✓
Soft close hinges	✓
Fakro rooflight	✓

Dining Area

Freestanding dining table and chairs	✓
--------------------------------------	---

Bathroom(s)

Shower in main bathroom & ensuite	✓
Extractor fan to main bathroom & ensuite	✓
Fakro rooflight in main bathroom & ensuite (in 2 bed model)	✓

Master Bedroom

TV point	✓
Kingsize lift up bed	✓
Walk in wardrobe	✓

Bedroom(s)

3ft' single beds	✓
TV point	✓
Sliding mirrored robes	✓

Throughout

Central heating	✓
Extra insulation	✓
Low energy lighting	✓
Sockets with USB port	✓

Exterior

Pre-galvanised chassis	✓
Graphite PVC double glazing	✓
Rigid PVC exterior finish	✓
Front sliding patio doors	✓
Exterior light	✓

POPULAR OPTIONS

Ultrawarm insulation	
BS3632 residential specification	
French doors to master bedroom side or rear aspect on 2 bed model	
Fully galvanised chassis	
Environmental colours	
Canoxel cladding coloured windows	
Timber cladding oak windows	
Tongue & groove panelled ceiling	
Additional roof light in kitchen (offside)	
Integrated washer/dryer*	
Integrated washing machine*	
Integrated 18 bottle wine cooler	
Pull out larder unit	
TV unit	
Lounge footstool	
Floor lamp	
Standard bedding set	
Deluxe bedding set	
Upgrade to divan beds (both bedrooms)	

**Only 1 full size appliance per model*

FLOOR PLANS

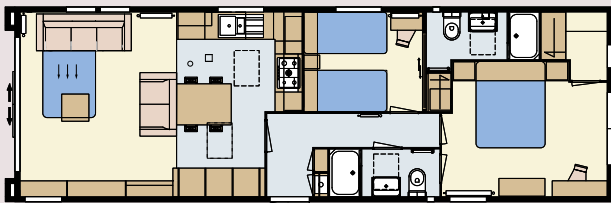

43 x 14 – 2 bedroom/4 berth

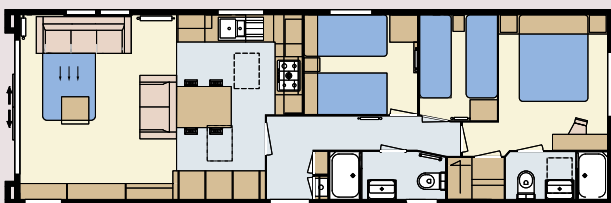

43 x 14 – 3 bedroom/6 berth

Please take a moment to choose which options you would like to be included in your new Jasmine Lodge.

You can tick the appropriate box, which will help you specify your new holiday home.

Please see the matrix on page 52 for a comprehensive list of options.